

FOLOK™



FOLOK™

名称	图例	页码
Tube 管对焊接头		
Tube 管对焊-阳螺纹接头 - MW		02
Tube 管对焊-阴螺纹接头 - FW		03
Tube 管对焊变径直通接头 - UW		03
Tube 管对焊弯头 - LUW		03
Tube 管对焊三通 - TW		04
Tube 管对焊四通 - CW		05
Tube 管插焊接头		
Tube 管插焊-阳螺纹接头 - MW		06
Tube 管插焊-阴螺纹接头 - FW		06
Tube 管插焊-阳螺纹弯头 - LMW		07
Tube 管插焊-阴螺纹弯头 - LFW		07
Tube 管插焊直通接头 - UW		07
Tube 管插焊变径直通接头 - UW		08
Tube 管插焊弯头 - LUW		08
Tube 管插焊 45° 弯头 - VW		09
Tube 管插焊三通 - TW		09
Tube 管插焊四通 - CW		10

名称	图例	页码
Pipe 管对焊接头		
Pipe 管对焊-阳螺纹接头 - MW		11
Pipe 管对焊-阴螺纹接头 - FW		11
Pipe 管插焊接头		
Pipe 管插焊-阳螺纹接头 - MW		12
Pipe 管插焊-阴螺纹接头 - FW		12
Pipe 管插焊直通接头 - UW		12
焊接转换接头		
Tube 管对焊-Tube 管插焊直通接头 - AW		13
Pipe 管对焊-Tube 管插焊直通接头 - AW		13
焊接活接接头		
阴螺纹-焊接活接接头 - PUW		14
阳螺纹-焊接活接接头 - MUW		15
订购信息		16

- ◎ 标准材料为 316 不锈钢，其他材料可按需提供。
- ◎ 直接头用高质量的棒料加工，其他形状的连接用锻件制造。
- ◎ 所有接口高质量的机械加工，保证了正确连接。
- ◎ 弯头通道圆弧连接，确保流体平稳流动。
- ◎ 每个接头都经过去毛刺及除油脂处理。
- ◎ 每个接头上都刻有尺寸、材料和材料炉号。

- ◎ 尺寸范围从 1/8" 至 1" 和 6 mm 至 38 mm。
- ◎ 工作温度：

316 不锈钢	-325°F (-198°C)	1000°F (538°C)
316L 不锈钢	-325°F (-198°C)	850°F (454°C)
904L 不锈钢	-325°F (-198°C)	700°F (371°C)

◎ 工作压力：

1. 样本所示工作压力值是在室温下以 ANSI/ASME B31.3 为基准。当要按 ANSI/ASME B31.1 标准确定工作压力时，将样本所示的工作压力乘以 0.94。
2. 要得到更高温度的许用工作压力，用环境温度下的许用工作压力乘以升温系数。关于升温系数，请参阅详见《FOLOK不锈钢管》样本第2页。

316 不锈钢	ASTM A276, ASME SA479	ASTM A182, ASME SA182	SS
316L 不锈钢			6L
904L 不锈钢	ASTM B649	ASTM A182	904L

- ◎ 使用相同材料，可保证相同的膨胀系数和良好的焊接性能。
- ◎ 推荐使用钨极惰性气体焊接(TIG)。

◎ FOLOK 焊接接头订购代码按如下格式：

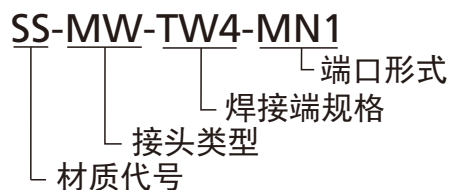

如果材质为316不锈钢, 材质代码“SS”可省略。

Tube

Tube -

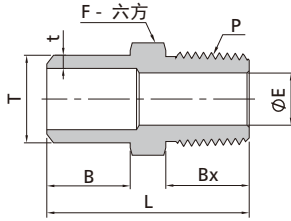

Tube					NPT				
T-Tube (in.)	t- (in.)	P-NPT	mm					psig (bar)	
			L	B	Bx	F	E		
1/4	0.065	1/4	-MW-TB4-MN4	29.7	9.7	14.2	14.3	7.1	8000 (551)
1/4	0.065	1/2	-MW-TB4-MN8	36.8	9.7	19.1	22.2	11.9	7700 (530)
3/8	0.095	1/4	-MW-TB6-MN4	29.7	9.7	14.2	14.3	7.1	8000 (551)
3/8	0.095	1/2	-MW-TB6-MN8	36.8	9.7	19.1	22.2	11.9	7700 (530)
1/2	0.095	1/4	-MW-TB8-MN4	34.3	14.2	14.2	14.3	7.1	6780 (468)
1/2	0.095	1/2	-MW-TB8-MN8	41.4	14.2	19.1	22.2	11.9	6780 (468)
5/8	0.109	1/4	-MW-TB10-MN4	34.8	14.2	14.2	17.5	7.1	5760 (397)
5/8	0.109	1/2	-MW-TB10-MN8	41.4	14.2	19.1	22.2	11.9	5760 (397)
3/4	0.120	1/4	-MW-TB12-MN4	40.1	19.1	14.2	20.6	7.1	5530 (381)
3/4	0.120	1/2	-MW-TB12-MN8	46.2	19.1	19.1	22.2	11.9	5530 (381)
1	0.134	1/4	-MW-TB16-MN4	42.9	19.1	14.2	27.0	7.1	4480 (309)
1	0.134	1/2	-MW-TB16-MN8	47.8	19.1	19.1	27.0	11.9	4480 (309)

Tube					NPT				
T-Tube (mm)	t- (mm)	P-NPT	mm					psig (bar)	
			L	B	Bx	F	E		
12	2.2	1/4	-MW-MB12-MN4	34.3	14.2	14.2	14	7.1	6470 (446)
12	2.2	1/2	-MW-MB12-MN8	41.1	14.2	19.1	22	11.9	6470 (446)
14	2.5	1/4	-MW-MB14-MN4	34.3	14.2	14.2	15	7.1	6280 (433)
14	2.5	1/2	-MW-MB14-MN8	41.4	14.2	19.1	22	11.9	6280 (433)
15	2.5	1/4	-MW-MB15-MN4	34.8	14.2	14.2	16	7.1	5770 (398)
16	2.8	1/4	-MW-MB16-MN4	35.6	14.2	14.2	18	7.1	6140 (423)
16	2.8	1/2	-MW-MB16-MN8	41.1	14.2	19.1	22	11.9	6140 (423)
20	3.0	1/2	-MW-MB20-MN8	46.2	19.1	19.1	22	11.9	5110 (352)
22	3.0	1/4	-MW-MB22-MN4	41.2	19.1	14.2	24	7.1	4620 (319)
22	3.0	1/2	-MW-MB22-MN8	46.1	19.1	19.1	24	11.9	4620 (319)
25	3.5	3/4	-MW-MB25-MN12	47.8	19.1	19.1	27	15.7	4730 (326)
25	3.5	1	-MW-MB25-MN16	54.9	19.1	23.9	35	22.4	4730 (326)
28	4.0	1/2	-MW-MB28-MN8	54.2	21.4	19.1	30	11.9	4850 (335)

尺寸仅供参考，可能会有变更。

Tube

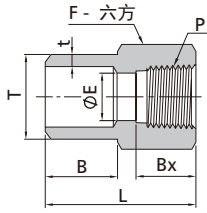

Tube					NPT					
T-Tube (in.)	t- (in.)	P-NPT		mm					psig (bar)	
				L	B	Bx	F	E		
1/4	0.065	1/4	-FW-TB4-FN4	27.9	9.7	15.0	19.1	3.0	6600 (454)	
1/4	0.065	3/8	-FW-TB4-FN6	29.5	9.7	15.0	22.2	3.0	5300 (365)	
3/8	0.095	1/4	-FW-TB6-FN4	27.9	9.7	15.0	19.1	4.7	6600 (454)	
3/8	0.095	3/8	-FW-TB6-FN6	29.5	9.7	15.0	22.2	4.7	5300 (365)	
1/2	0.095	1/4	-FW-TB8-FN4	34.0	14.2	15.0	19.1	7.9	6600 (454)	
1/2	0.095	3/8	-FW-TB8-FN6	34.0	14.2	15.0	22.2	7.9	5300 (365)	
1/2	0.095	1/2	-FW-TB8-FN8	38.9	14.2	19.8	27.0	7.9	4900 (337)	

Tube					NPT					
T-Tube (mm)	t- (mm)	P-NPT		mm					psig (bar)	
				L	B	Bx	F	E		
14	2.5	1/4	-FW-MB14-FN4	33.0	14.2	15.0	19	9.0	6280 (433)	
14	2.5	1/2	-FW-MB14-FN8	38.9	14.2	19.8	27	9.0	4900 (337)	
20	3.0	1/2	-FW-MB20-FN8	43.7	19.1	19.8	27	14.0	4900 (337)	
28	4.0	1/2	-FW-MB28-FN8	49.8	23.9	19.8	30	15.7	4850 (335)	

Tube

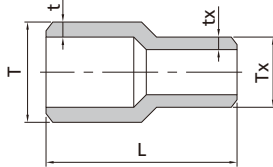

Tube					Tube	
T-Tube (in.)	t- (in.)	Tx-Tube (in.)	tx- (in.)		L (mm)	psig (bar)
3/8	0.095	1/4	0.065	-UW-TB6-TB4	38.1	9930 (685)
1/2	0.095	1/4	0.065	-UW-TB8-TB4	38.1	6780 (468)
1/2	0.095	3/8	0.095	-UW-TB8-TB6	38.1	6780 (468)
3/4	0.120	1/2	0.095	-UW-TB12-TB8	38.1	5530 (381)
1	0.134	3/4	0.120	-UW-TB16-TB12	38.1	4480 (309)

Tube					Tube	
T-Tube (mm)	t- (mm)	Tx-Tube (mm)	tx- (mm)		L (mm)	psig (bar)
20	3.0	14	2.5	-UW-MB20-MB14	38.1	6470 (445)
22	3.0	14	2.5	-UW-MB22-MB14	38.1	5780 (395)
22	3.0	18	2.8	-UW-MB22-MB18	38.1	5780 (395)
25	3.5	22	3.0	-UW-MB25-MB22	38.1	5780 (395)
38	5.0	25	3.5	-UW-MB38-MB25	38.1	5540 (380)

Tube

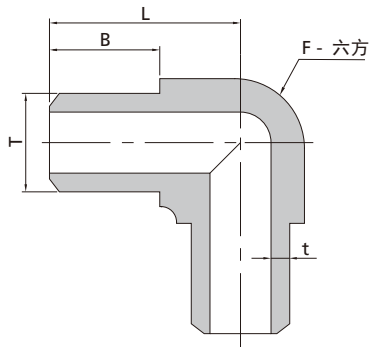

Tube						
T-Tube (in.)	t- (in.)		mm			psig (bar)
			L	B	F	
1/4	0.065	-LUW-TB4	16.3	9.7	9.5	10320 (712)
3/8	0.095	-LUW-TB6	18.0	9.7	11.1	9930 (685)
1/2	0.095	-LUW-TB8	24.4	14.2	14.3	6780 (468)
3/4	0.120	-LUW-TB12	33.3	19.1	20.6	5530 (381)
1	0.134	-LUW-TB16	37.1	19.1	27.0	4480 (309)

Tube						
T-Tube (mm)	t- (mm)		mm			psig (bar)
			L	B	F	
10	2.2	-LUW-MB10	18.0	9.7	11.1	8160 (563)
14	2.5	-LUW-MB14	25.4	14.2	15.9	6280 (433)
16	2.8	-LUW-MB16	26.2	14.2	17.5	6140 (423)
20	3.0	-LUW-MB20	33.3	19.1	20.6	5110 (352)
22	3.0	-LUW-MB22	35.3	19.1	23.8	4620 (319)
25	3.5	-LUW-MB25	37.1	19.1	27.0	4730 (326)

Tube

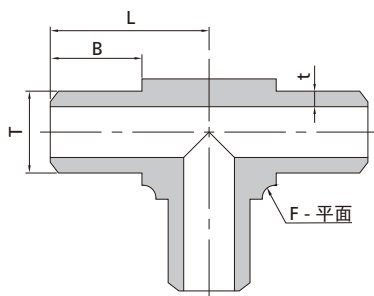

Tube						
T-Tube (in.)	t- (in.)		mm			psig (bar)
			L	B	F	
1/4	0.065	-TW-TB4	16.3	9.7	9.5	10320 (712)
3/8	0.095	-TW-TB6	18.0	9.7	11.1	9930 (685)
1/2	0.095	-TW-TB8	24.4	14.2	14.3	6780 (468)
3/4	0.120	-TW-TB12	33.3	19.1	20.6	5530 (381)
1	0.134	-TW-TB16	37.1	19.1	27.0	4480 (309)

Tube						
T-Tube (mm)	t- (mm)		mm			psig (bar)
			L	B	F	
6	1.8	-TW-MB6	16.3	9.7	9.5	12660 (873)
8	1.8	-TW-MB8	16.3	9.7	9.5	8320 (574)
10	2.2	-TW-MB10	18.0	9.7	11.1	8160 (563)
12	2.2	-TW-MB12	24.4	14.2	14.3	6470 (446)
14	2.5	-TW-MB14	25.4	14.2	15.9	6280 (433)
16	2.8	-TW-MB16	26.2	14.2	17.5	6140 (423)
20	3.0	-TW-MB20	33.3	19.1	20.6	5110 (352)
22	3.0	-TW-MB22	35.3	19.1	23.8	4620 (319)
25	3.5	-TW-MB25	37.1	19.1	27.0	4730 (326)
32	4.5	-TW-MB32	49.3	23.9	34.9	4730 (326)

Tube

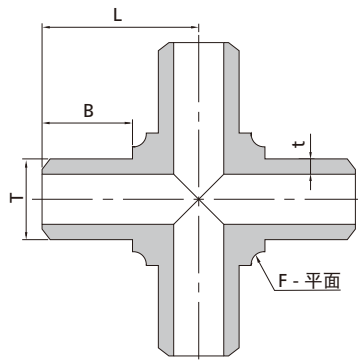

Tube						
T-Tube (in.)	t- (in.)		mm			psig (bar)
			L	B	F	
1/4	0.065	-CW-TB4	16.3	9.7	9.5	10320 (712)
3/8	0.095	-CW-TB6	18.0	9.7	11.1	9930 (685)
1/2	0.095	-CW-TB8	24.4	14.2	14.3	6780 (468)
3/4	0.120	-CW-TB12	33.3	19.1	20.6	5530 (381)
1	0.134	-CW-TB16	37.1	19.1	27.0	4480 (309)

Tube						
T-Tube (mm)	t- (mm)		mm			psig (bar)
			L	B	F	
6	1.8	-CW-MB6	16.3	9.7	9.5	12660 (873)
8	1.8	-CW-MB8	16.3	9.7	9.5	8320 (574)
10	2.2	-CW-MB10	18.0	9.7	11.1	8160 (563)

Tube

Tube -

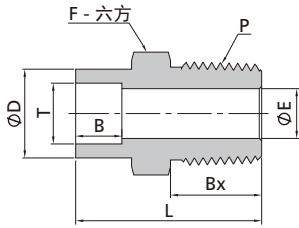

Tube		NPT							
T-Tube (in.)	P-NPT		mm						psig (bar)
			L	D	B	Bx	F	E	
1/4	1/4	-MW-TW4-MN4	29.2	12.2	7.1	14.2	14.3	4.8	8000 (551)
3/8	1/4	-MW-TW6-MN4	31.8	15.2	7.9	14.2	15.9	7.1	8000 (551)
3/8	3/8	-MW-TW6-MN6	31.8	15.2	7.9	14.2	17.5	7.1	7800 (537)
3/8	1/2	-MW-TW6-MN8	37.3	15.2	7.9	19.1	22.2	7.1	7700 (530)
1/2	1/4	-MW-TW8-MN4	33.3	18.5	9.7	14.2	19.1	7.1	6600 (454)
1/2	3/8	-MW-TW8-MN6	33.3	18.5	9.7	14.2	19.1	9.6	6600 (454)
1/2	1/2	-MW-TW8-MN8	38.9	18.5	9.7	19.1	22.2	10.4	6600 (454)
3/4	3/4	-MW-TW12-MN12	45.1	26.4	11.2	19.1	27.0	15.7	5900 (406)
1	1	-MW-TW16-MN16	53.6	34.5	15.7	23.9	34.9	22.4	5300 (365)

Tube		NPT							
T-Tube (mm)	P-NPT		mm						psig (bar)
			L	D	B	Bx	F	E	
6	1/4	-MW-MW6-MN4	29.2	12.0	7.1	14.2	14	4.8	8000 (551)
12	1/2	-MW-MW12-MN8	38.9	20.2	9.7	19.1	22	9.5	6820 (470)
14	1/4	-MW-MW14-MN4	33.3	23.8	10.0	14.2	24	7.1	6930 (478)
14	3/8	-MW-MW14-MN6	35.0	23.8	10.0	14.2	24	9.6	6930 (478)
14	1/2	-MW-MW14-MN8	40.0	23.8	10.0	19.1	24	10.4	6930 (478)
16	1/4	-MW-MW16-MN4	35.0	23.8	10.4	14.2	24	7.1	6190 (426)
16	1/2	-MW-MW16-MN8	40.0	23.8	10.4	19.1	24	11.9	6190 (426)
18	1/4	-MW-MW18-MN4	40.4	26.0	11.2	14.2	27	7.1	6050 (417)
28	3/4	-MW-MW28-MN12	55.5	40.0	20.0	19.1	41	15.7	5040 (348)
38	1 1/4	-MW-MW38-MN20	68.3	50.8	22.0	23.9	52	28.6	5000 (344)

Tube -

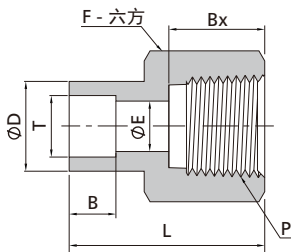

Tube		NPT							
T-Tube (in.)	P-NPT		mm						psig (bar)
			L	D	B	Bx	F	E	
1/8	1/8	-FW-TW2-FN2	21.1	7.4	2.5	10.4	14.3	2.3	6500 (447)
1/4	1/8	-FW-TW4-FN2	26.7	12.2	7.1	10.4	14.3	4.8	6500 (447)
1/4	1/4	-FW-TW4-FN4	30.0	12.2	7.1	15.0	19.1	4.8	6600 (454)
3/8	1/4	-FW-TW6-FN4	31.5	15.2	7.9	15.0	19.1	7.1	6600 (454)
1/2	3/8	-FW-TW8-FN6	34.5	18.5	9.7	15.0	22.2	10.4	5300 (365)
1/2	1/2	-FW-TW8-FN8	40.4	18.5	9.7	19.8	27.0	10.4	4900 (337)
3/4	3/4	-FW-TW12-FN12	43.9	26.4	11.2	20.6	33.3	16.0	4600 (316)
1	1	-FW-TW16-FN16	54.1	34.5	15.7	25.4	41.3	22.4	4400 (303)

Tube		NPT							
T-Tube (mm)	P-NPT		mm						psig (bar)
			L	D	B	Bx	F	E	
8	1/4	-FW-MW8-FN4	27.0	14.3	7.9	15.0	19	4.8	6600 (454)
10	1/4	-FW-MW10-FN4	29.0	16.5	7.9	15.0	19	7.1	6600 (454)
14	1/4	-FW-MW14-FN4	32.0	23.8	10.0	15.0	24	9.5	6930 (478)
28	3/4	-FW-MW28-FN12	54.1	40.0	20.0	20.6	41	19.8	4600 (316)

Tube -

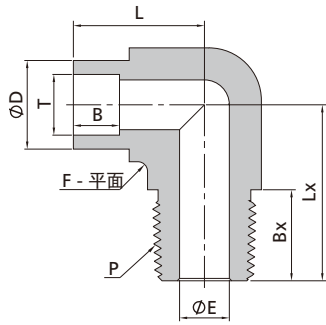

Tube				NPT							
T-Tube		P-NPT	(in.)	mm							psig (bar)
L	B			Lx	D	B	Bx	F	E		
1/4	1/4	-LMW-TW4-MN4	20.1	26.7	14.7	7.1	14.2	12.7	4.8	8000 (551)	
3/8	1/4	-LMW-TW6-MN4	26.4	26.7	14.7	7.9	14.2	12.7	7.1	8000 (551)	
3/8	3/8	-LMW-TW6-MN6	24.6	29.7	20.2	7.9	14.2	17.5	7.1	7800 (537)	
3/8	1/2	-LMW-TW6-MN8	25.9	36.8	23.8	7.9	19.1	20.6	7.1	7700 (530)	
1/2	1/2	-LMW-TW8-MN8	27.4	36.8	23.8	9.7	19.1	20.6	10.4	6600 (454)	
3/4	3/4	-LMW-TW12-MN12	38.9	39.6	26.4	11.2	19.1	27.0	15.7	5900 (406)	

Tube -

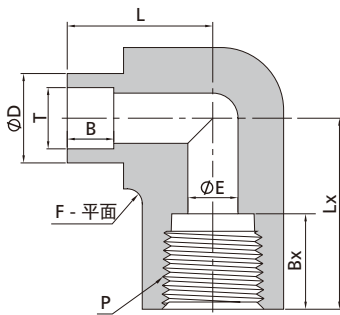

Tube				NPT							
T-Tube		P-NPT	(in.)	mm							psig (bar)
L	B			Lx	D	B	Bx	F	E		
1/4	1/4	-LFW-TW4-FN4	22.9	29.7	20.2	7.1	15.0	17.5	4.8	7400 (509)	
3/8	1/4	-LFW-TW6-FN4	25.1	29.7	20.2	7.9	15.0	17.5	7.1	7400 (509)	
3/8	1/2	-LFW-TW6-FN8	28.7	39.6	29.3	7.9	19.8	25.4	7.1	5700 (392)	
1/2	1/2	-LFW-TW8-FN8	30.2	39.6	29.3	9.7	19.8	25.4	10.4	5700 (392)	

Tube

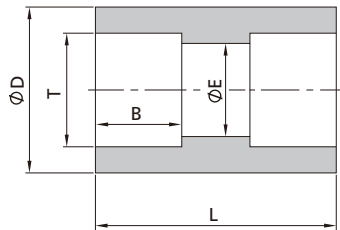

Tube		mm				psig (bar)
T-Tube	(in.)	L	D	B	E	
1/4	-UW-TW4	19.1	12.2	7.1	4.8	10700 (737)
3/8	-UW-TW6	22.4	15.2	7.9	7.1	8100 (558)
1/2	-UW-TW8	26.9	18.5	9.7	10.4	6600 (454)
5/8	-UW-TW10	30.2	23.4	10.4	12.7	6200 (427)
3/4	-UW-TW12	33.3	26.4	11.2	16.0	5900 (406)
7/8	-UW-TW14	35.5	31.5	12.7	18.8	5730 (395)
1	-UW-TW16	36.6	34.5	15.7	22.4	5600 (385)

Tube		mm				psig (bar)
T-Tube	(mm)	L	D	B	E	
8	-UW-MW8	22.4	14.3	7.9	6.4	9790 (675)
10	-UW-MW10	23.6	16.5	7.9	7.4	8100 (558)
12	-UW-MW12	26.9	20.2	9.7	9.5	6820 (470)
14	-UW-MW14	28.0	23.8	10.0	10.4	6930 (478)
16	-UW-MW16	30.2	23.8	10.4	12.7	6190 (426)
20	-UW-MW20	28.0	27.0	11.2	17.0	5510 (380)

Tube

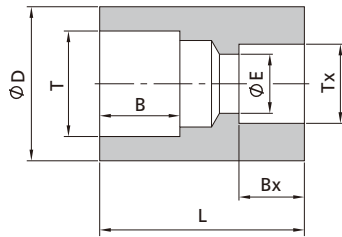

Tube		Tube						
T-Tube	Tx-Tube	mm					psig (bar)	
(in.)	(in.)	L	D	B	E	Bx		
3/8	1/4	-UW-TW6-TW4	22.4	15.2	7.9	4.8	7.1	8100 (558)
1/2	1/4	-UW-TW8-TW4	24.3	18.5	9.7	4.8	7.1	6600 (454)
1/2	3/8	-UW-TW8-TW6	26.1	18.5	9.7	7.1	7.9	6600 (454)
3/4	3/8	-UW-TW12-TW6	29.8	26.4	11.2	7.1	7.9	5900 (406)
3/4	1/2	-UW-TW12-TW8	31.6	26.4	11.2	10.4	9.7	5900 (406)
1	3/4	-UW-TW16-TW12	32.1	34.5	15.7	16.0	11.2	5600 (385)

Tube		Tube						
T-Tube	Tx-Tube	mm					psig (bar)	
(mm)	(mm)	L	D	B	E	Bx		
14	10	-UW-MW14-MW10	26.0	23.8	10.4	7.4	7.9	6930 (478)
25	14	-UW-MW25-MW14	30.0	34.5	15.7	10.4	10.0	5450 (376)
25	22	-UW-MW25-MW22	35.8	34.5	15.7	19.0	13.5	5450 (376)

Tube		Tube						
T-Tube	Tx-Tube	mm					psig (bar)	
(mm)	(in.)	L	D	B	E	Bx		
20	3/4	-UW-MW20-TW12	28.0	27.0	11.2	15.7	11.2	5510 (380)
28	3/4	-UW-MW28-TW12	36.8	40.0	20.0	15.7	11.2	5040 (348)

Tube

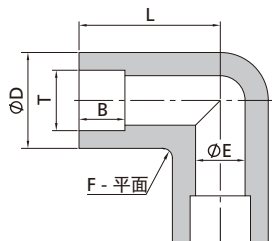

Tube		Tube					psig (bar)	
T-Tube		mm						
(in.)		L	D	B	F	E		
1/8		-LUW-TW2	15.0	11.0	2.5	9.5	2.3	12600 (863)
1/4		-LUW-TW4	21.8	12.8	7.1	11.1	4.8	10700 (737)
3/8		-LUW-TW6	26.4	16.5	7.9	14.3	7.1	8100 (558)
1/2		-LUW-TW8	29.7	20.2	9.7	17.5	10.4	6600 (454)
5/8		-LUW-TW10	36.1	23.8	10.4	20.6	12.7	6200 (427)
3/4		-LUW-TW12	39.6	29.3	11.2	25.4	16.0	5900 (406)
1		-LUW-TW16	48.8	36.7	15.7	31.8	22.4	5600 (385)

Tube		Tube					psig (bar)	
T-Tube		mm						
(mm)		L	D	B	F	E		
10		-LUW-MW10	24.6	16.5	7.9	14.3	7.4	8100 (558)
12		-LUW-MW12	29.7	20.2	9.7	17.5	9.5	6820 (470)
14		-LUW-MW14	31.7	23.8	10.0	20.6	10.4	6930 (478)
16		-LUW-MW16	34.7	23.8	10.4	20.6	12.7	6190 (426)

Tube 45°

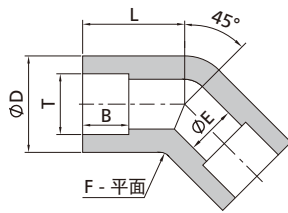

T-Tube		mm					psig (bar)
(in.)		L	D	B	F	E	
1/4	-VW-TW4	15.0	14.7	7.1	12.7	4.8	10700 (737)
3/8	-VW-TW6	19.1	16.5	7.9	14.3	7.1	8100 (558)
1/2	-VW-TW8	21.3	20.2	9.7	17.5	10.4	6600 (454)
3/4	-VW-TW12	28.7	29.3	11.2	25.4	16.0	5900 (406)
1	-VW-TW16	31.8	36.7	15.7	31.8	22.4	5600 (385)

T-Tube		mm					psig (bar)
(mm)		L	D	B	F	E	
8	-VW-MW8	17.3	14.7	7.9	12.7	6.4	9790 (675)
10	-VW-MW10	19.1	16.5	7.9	14.3	7.4	8100 (558)
12	-VW-MW12	21.3	20.2	9.7	17.5	9.5	6820 (470)
14	-VW-MW14	26.4	23.8	10.0	20.6	10.4	6930 (478)
16	-VW-MW16	26.4	23.8	10.4	20.6	12.7	6190 (426)
20	-VW-MW20	28.7	29.3	11.2	25.4	17.0	5510 (380)
22	-VW-MW22	29.7	31.2	13.5	27.0	19.0	6850 (472)
25	-VW-MW25	31.8	36.7	15.7	31.8	22.0	5450 (376)

Tube

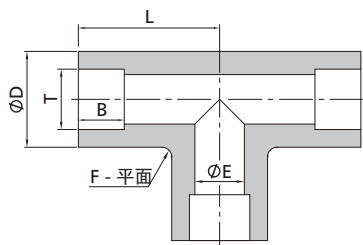

T-Tube		mm					psig (bar)
(in.)		L	D	B	F	E	
1/8	-TW-TW2	15.0	10.0	2.5	11.1	2.3	12600 (868)
1/4	-TW-TW4	21.8	12.8	7.1	11.1	4.8	10700 (737)
3/8	-TW-TW6	26.4	16.5	7.9	14.3	7.1	8100 (558)
1/2	-TW-TW8	29.7	20.2	9.7	17.5	10.4	6600 (454)
5/8	-TW-TW10	36.1	23.8	10.4	20.6	12.7	6200 (428)
3/4	-TW-TW12	39.6	29.3	11.2	25.4	16.0	5900 (406)
1	-TW-TW16	48.8	36.7	15.7	31.8	22.4	5600 (385)

T-Tube		mm					psig (bar)
(mm)		L	D	B	F	E	
8	-TW-MW8	19.8	14.7	7.9	12.7	6.4	9790 (675)
10	-TW-MW10	24.6	16.5	7.9	14.3	7.4	8100 (558)
12	-TW-MW12	29.7	20.2	9.7	17.5	9.5	6820 (470)
14	-TW-MW14	31.7	23.8	10.0	20.6	10.4	6930 (478)
16	-TW-MW16	36.0	23.8	10.4	20.6	12.7	6190 (426)
20	-TW-MW20	39.6	29.3	11.2	25.4	17.0	5510 (380)
22	-TW-MW22	41.3	31.2	13.5	27.0	19.0	6850 (472)
25	-TW-MW25	48.8	36.7	15.7	31.8	22.0	5450 (376)

Tube

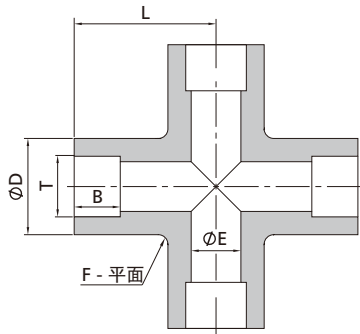

Tube							
T-Tube (in.)		mm					psig (bar)
		L	D	B	F	E	
1/8	-CW-TW2	15.0	11.0	2.5	11.1	2.3	12600 (863)
1/4	-CW-TW4	21.8	12.8	7.1	11.1	4.8	10700 (737)
3/8	-CW-TW6	26.4	14.7	7.9	12.7	7.1	8100 (558)
1/2	-CW-TW8	29.7	20.2	9.7	17.5	10.4	6600 (454)
5/8	-CW-TW10	36.1	23.8	10.4	20.6	12.7	6200 (428)
3/4	-CW-TW12	39.6	29.3	11.2	25.4	16.0	5900 (406)
1	-CW-TW16	48.8	36.7	15.7	31.8	22.4	5600 (385)

Tube							
T-Tube (mm)		mm					psig (bar)
		L	D	B	F	E	
8	-CW-MW8	19.8	14.7	7.9	12.7	6.4	9790 (675)
10	-CW-MW10	24.6	16.5	7.9	14.3	7.1	8100 (558)
12	-CW-MW12	29.7	20.2	9.7	17.5	9.5	6820 (470)
14	-CW-MW14	31.7	23.8	10.0	20.6	10.4	6930 (478)
16	-CW-MW16	36.0	23.8	10.4	20.6	12.7	6190 (426)
20	-CW-MW20	39.6	29.3	11.2	25.4	17.0	5510 (380)
22	-CW-MW22	41.3	31.2	13.5	27.0	19.0	6850 (472)
25	-CW-MW25	48.8	36.7	15.7	31.8	22.0	5450 (376)

Pipe

Pipe -

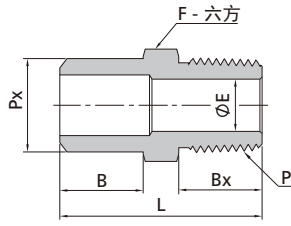

Pipe			mm					NPT
Px-Sch80 Pipe	P-NPT		mm					psig (bar)
			L	B	Bx	F	E	
1/4	1/4	-MW-PB4-MN4	34.3	14.2	14.2	14.3	7.1	8000 (551)
1/4	1/2	-MW-PB4-MN8	41.3	14.2	19.1	22.2	7.7	7700 (537)
3/8	1/4	-MW-PB6-MN4	34.8	14.2	14.2	17.5	7.1	6650 (459)
3/8	1/2	-MW-PB6-MN8	41.3	14.2	19.1	22.2	10.7	6650 (459)
1/2	1/4	-MW-PB8-MN4	41.3	19.1	14.2	22.2	7.1	6190 (427)
1/2	1/2	-MW-PB8-MN8	46.2	19.1	19.1	22.2	11.9	6190 (427)
3/4	1/4	-MW-PB12-MN4	42.9	19.1	14.2	27.0	7.1	5040 (348)
3/4	1/2	-MW-PB12-MN8	47.8	19.1	19.1	27.0	11.9	5040 (348)
1	1/4	-MW-PB16-MN4	50.0	23.9	14.2	34.9	7.1	4640 (320)
1	1/2	-MW-PB16-MN8	54.9	23.9	19.1	34.9	11.9	4640 (320)

Pipe -

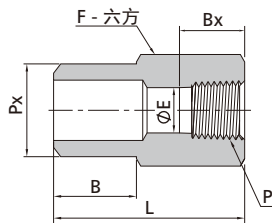

Pipe			mm					NPT
Px-Sch80 Pipe	P-NPT		mm					psig (bar)
			L	B	Bx	F	E	
1/4	1/2	-FW-PB4-FN8	38.9	14.2	19.8	27.0	7.6	4900 (337)
3/8	1/2	-FW-PB6-FN8	38.9	14.2	19.8	27.0	10.7	4900 (337)
1/2	1/4	-FW-PB8-FN4	37.3	19.1	15.0	22.2	10.4	7500 (516)
1/2	1/2	-FW-PB8-FN8	43.7	19.1	19.8	27.0	13.9	4900 (337)

Pipe

Pipe

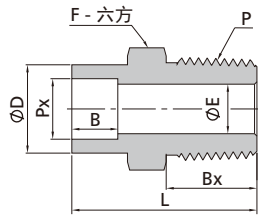

Pipe		NPT							
Px-Pipe	P-NPT	mm						psig (bar)	
		L	D	B	Bx	F	E		
1/4	1/4	-MW-PW4-MN4	35.2	22.4	9.9	14.2	23.8	7.1	8000 (551)
1/4	1/2	-MW-PW4-MN8	40.0	22.4	9.9	19.1	23.8	9.1	7700 (530)
3/8	3/8	-MW-PW6-MN6	38.0	26.2	9.9	14.2	27.0	9.7	7100 (489)
3/8	1/2	-MW-PW6-MN8	42.9	26.2	9.9	19.1	27.0	11.9	7100 (489)
1/2	3/8	-MW-PW8-MN6	40.3	31.8	9.9	14.2	33.3	9.7	6800 (468)
1/2	1/2	-MW-PW8-MN8	45.2	31.8	9.9	19.1	33.3	11.9	6800 (468)
3/4	1/2	-MW-PW12-MN8	54.3	37.3	13.0	19.1	38.1	11.9	5800 (399)
3/4	3/4	-MW-PW12-MN12	54.3	37.3	13.0	19.1	38.1	15.7	5800 (399)
1	3/4	-MW-PW16-MN12	55.8	47.2	13.0	19.1	47.6	15.7	6100 (420)
1	1	-MW-PW16-MN16	60.6	47.2	13.0	23.9	47.6	22.4	5300 (365)

Pipe

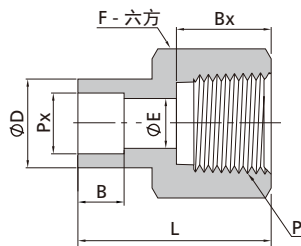

Pipe		NPT							
Px-Pipe	P-NPT	mm						psig (bar)	
		L	D	B	Bx	F	E		
1/4	1/4	-FW-PW4-FN4	33.5	22.4	9.9	15.0	23.8	9.1	8000 (551)
1/4	3/8	-FW-PW4-FN6	33.5	22.4	9.9	15.0	23.8	9.1	6790 (463)
3/8	3/8	-FW-PW6-FN6	34.1	26.2	9.9	15.0	27.0	12.4	7100 (489)
3/8	1/2	-FW-PW6-FN8	39.1	26.2	9.9	19.8	27.0	12.4	4900 (337)
1/2	1/2	-FW-PW8-FN8	40.0	31.8	9.9	19.8	33.3	15.7	6800 (468)
1/2	3/4	-FW-PW8-FN12	40.6	31.8	9.9	20.6	33.3	15.7	4600 (316)
3/4	3/4	-FW-PW12-FN12	53.2	37.3	13.0	20.6	38.1	20.8	5800 (399)
3/4	1	-FW-PW12-FN16	58.1	37.3	13.0	25.4	41.3	20.8	4400 (303)

Pipe

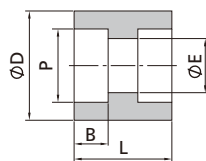

Pipe		mm				psig (bar)
P-Pipe		L	D	B	E	
1/8	-UW-PW2	25.7	17.1	9.9	7.0	8230 (568)
1/4	-UW-PW4	26.9	22.4	9.9	9.1	8000 (551)
3/8	-UW-PW6	28.4	26.2	9.9	12.4	7100 (489)
1/2	-UW-PW8	29.5	31.8	9.9	15.7	6800 (468)
3/4	-UW-PW12	44.5	37.3	13.0	20.8	5800 (399)
1	-UW-PW16	44.5	47.2	13.0	26.7	6100 (420)

Tube - Tube

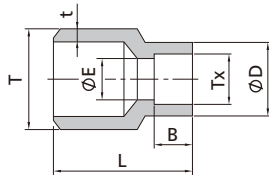

Tube									
T-Tube (in.)	t- (in.)	Tx-Tube (in.)		mm				psig (bar)	
				L	B	D	E		
1/4	0.083	1/8	-AW-TB4-TW2	14.2	2.5	8.0	2.3	12600 (868)	
3/8	0.095	1/4	-AW-TB6-TW4	19.1	7.1	12.2	4.8	8200 (564)	
1/2	0.095	1/4	-AW-TB8-TW4	22.4	7.1	12.7	4.8	7500 (516)	
1/2	0.095	3/8	-AW-TB8-TW6	22.4	7.9	15.2	7.1	7500 (516)	
3/4	0.120	1/2	-AW-TB12-TW8	28.4	9.7	18.5	10.4	6300 (434)	
1	0.134	1/2	-AW-TB16-TW8	35.1	9.7	18.5	10.4	5300 (365)	
1	0.134	3/4	-AW-TB16-TW12	38.1	11.2	26.4	16.0	5300 (365)	

Pipe - Tube

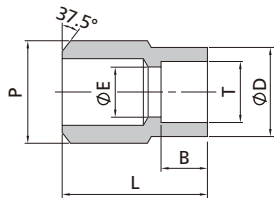

Pipe				Tube				
P-Sch80 Pipe	T-Tube (in.)			mm				psig (bar)
				L	B	D	E	
1/4	1/4	-AW-PB4-TW4		22.4	7.1	12.2	4.8	10810 (744)
3/8	1/4	-AW-PB6-TW4		26.2	7.9	12.2	4.8	8500 (586)
3/8	3/8	-AW-PB6-TW6		26.2	7.9	15.2	7.1	8500 (586)
3/8	1/2	-AW-PB6-TW8		25.4	9.7	18.5	10.4	6930 (476)
1/2	1/4	-AW-PB8-TW4		28.4	7.1	12.2	4.8	8190 (563)
1/2	3/8	-AW-PB8-TW6		28.4	7.9	15.2	7.1	8190 (563)
1/2	1/2	-AW-PB8-TW8		30.2	9.7	18.5	10.4	6930 (476)
3/4	1/4	-AW-PB12-TW4		38.1	7.1	12.2	4.8	6930 (476)
3/4	3/8	-AW-PB12-TW6		38.1	7.9	15.2	7.1	6930 (476)
3/4	1/2	-AW-PB12-TW8		38.1	9.7	18.5	10.4	6930 (476)
3/4	3/4	-AW-PB12-TW12		38.1	11.2	26.4	16.0	6190 (483)
1	3/8	-AW-PB16-TW6		35.1	7.9	15.2	7.1	6300 (434)
1	1/2	-AW-PB16-TW8		39.6	9.7	18.5	10.4	6300 (434)

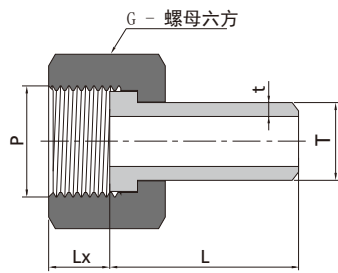

ISO				Tube			
P-ISO	T-Tube (mm)	t- (mm)		mm			psig (bar)
				L	G	Lx	
1/2	12	2.2	-PUW-FRP8-MB12	34	27.0	11	6470 (446)
1/2	14	2.5	-PUW-FRP8-MB14	34	27.0	11	6280 (433)
1/2	16	2.8	-PUW-FRP8-MB16	34	27.0	11	6140 (423)

				Tube			
P-	T-Tube (mm)	t- (mm)		mm			psig (bar)
				L	G	Lx	
M12 x 1.5	6	1.8	-PUW-FM12-MB6	25	16	9	12660 (873)
M12 x 1.5	8	1.8	-PUW-FM12-MB8	30	16	9	8320 (574)
M14 x 1.5	8	1.8	-PUW-FM14-MB8	30	18	9	8320 (574)
M14 x 1.5	10	2.2	-PUW-FM14-MB10	30	18	9	8160 (563)
M16 x 1.5	8	1.8	-PUW-FM16-MB8	30	22	9	8320 (574)
M16 x 1.5	10	2.2	-PUW-FM16-MB10	30	22	9	8160 (563)
M16 x 1.5	12	2.2	-PUW-FM16-MB12	34	22	9	6470 (446)
M18 x 1.5	10	2.2	-PUW-FM18-MB10	34	22	10	8160 (563)
M18 x 1.5	12	2.2	-PUW-FM18-MB12	34	22	10	6470 (446)
M18 x 1.5	14	2.5	-PUW-FM18-MB14	34	22	10	6280 (433)
M20 x 1.5	10	2.2	-PUW-FM20-MB10	34	25	11	8160 (563)
M20 x 1.5	12	2.2	-PUW-FM20-MB12	34	25	11	6470 (446)
M20 x 1.5	14	2.5	-PUW-FM20-MB14	34	25	11	6280 (433)
M20 x 1.5	15	2.5	-PUW-FM20-MB15	34	25	11	6160 (425)
M20 x 1.5	16	2.8	-PUW-FM20-MB16	34	25	11	6140 (423)
M22 x 1.5	14	2.5	-PUW-FM22-MB14	34	27	11	6280 (433)
M22 x 1.5	16	2.8	-PUW-FM22-MB16	34	27	11	6140 (423)
M24 x 1.5	16	2.8	-PUW-FM24-MB16	34	30	11	6140 (423)
M24 x 1.5	18	2.8	-PUW-FM24-MB18	34	30	11	5670 (392)
M24 x 1.5	20	3.0	-PUW-FM24-MB20	34	30	11	5110 (352)
M27 x 2	14	2.5	-PUW-FM27-MB14	34	32	14	6280 (433)
M27 x 2	16	2.8	-PUW-FM27-MB16	34	32	14	6140 (423)
M27 x 2	18	2.8	-PUW-FM27-MB18	34	32	14	5670 (392)
M27 x 2	20	3.0	-PUW-FM27-MB20	40	32	14	5110 (352)
M27 x 2	22	3.0	-PUW-FM27-MB22	40	32	14	4620 (319)
M30 x 2	22	3.0	-PUW-FM30-MB22	40	35	18	4620 (319)
M30 x 2	25	3.5	-PUW-FM30-MB25	45	35	18	4730 (326)
M33 x 2	28	4.0	-PUW-FM33-MB28	45	41	18	5160 (356)
M36 x 2	30	4.0	-PUW-FM36-MB30	45	41	18	4760 (328)

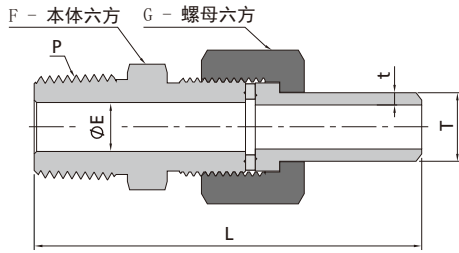

NPT				Tube				
P-NPT	T-Tube (mm)	t- (in.)		mm				psig (bar)
				L	F	G	E	
1/8	14	2.5	-MUW-MN2-MB14	69	19	22	4.8	6280 (433)
1/4	6	1.8	-MUW-MN4-MB6	60	14	14	3	8240 (566)
1/4	8	1.8	-MUW-MN4-MB8	73.2	14	16	4	8240 (566)
1/4	10	2.2	-MUW-MN4-MB10	73.2	15	18	6	8160 (563)
1/4	12	2.2	-MUW-MN4-MB12	73.2	18	22	7	6470 (446)
1/4	14	2.5	-MUW-MN4-MB14	73.2	19	22	7.1	6280 (433)
1/4	16	2.8	-MUW-MN4-MB16	73.2	22	25	7.1	6140 (423)
1/4	18	2.8	-MUW-MN4-MB18	74.2	24	27	7.1	5670 (392)
3/8	14	2.5	-MUW-MN6-MB14	73.2	19	22	9.7	6280 (433)
1/2	12	2.2	-MUW-MN8-MB12	78	18	22	7	6470 (446)
1/2	14	2.5	-MUW-MN8-MB14	78	19	22	9	6280 (433)
1/2	16	2.8	-MUW-MN8-MB16	78	22	25	10	6140 (423)
1/2	22	3.0	-MUW-MN8-MB22	82	30	32	11.9	4620 (319)
1/2	25	2.8	-MUW-MN8-MB25	86	32	35	11.9	4730 (326)
1	25	3.5	-MUW-MN16-MB25	103	35	35	17	4730 (326)

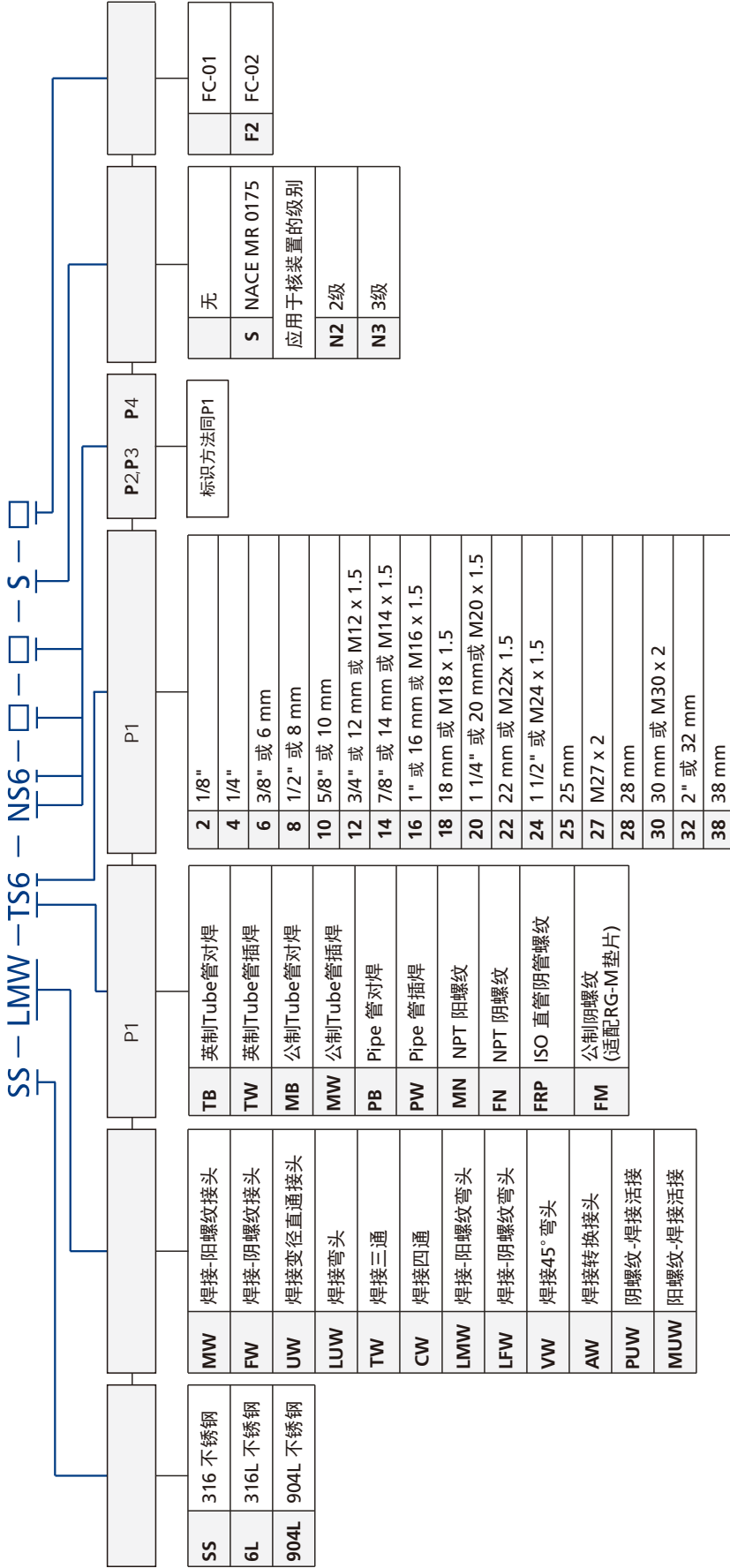

- P1, P2, P3 和 P4 端口应该按照以下规则来描述:
- 描述型号时, Pipe 管螺纹接头的命名在对焊接头之后 ("PUW" 和 "MUW" 除外)
 - Pipe 管对焊 - Tube 管对焊 - Pipe 管插焊 - Tube 管插焊 - 其他
 - 接头类型相同时, 按照接头尺寸大小编写。
 - 如果所有接头的类型和尺寸都相同, 只需描述 P1 端口。清洗和包装:
 - FC-01: 一般工业用的标准清洗和包装。
 - FC-02: 浸润系统组件的特殊清洗和包装, 应符合 ASTM G93 C 清洁要求。

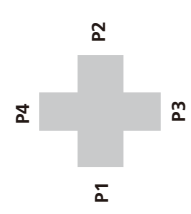

FOLOKTM

深圳市福洛克科技有限公司

地址：深圳市光明新区观光路第三工业区12号
星光华工业园B栋5楼B

电话：(86)-755-83755805 83755806

传真：(86)-755-83755022

邮编：518107

网址：www.folokinc.com